

Koper side control chain operated roller blind systems



The side control roller shade systems are designed to provide effective and efficient control of light, heat and glare in large and small scale commercial and domestic installations.

The mechanisms are designed for longevity with components manufactured using prime grade engineering thermoplastics in combination with aluminium, steel and stainless steel parts.

To satisfy most window types and the variety of window blind fabrics available, the system comes in a choice of models. Units feature higher drive ratios and spring assisted operation to reduce the pull force on large or heavy blinds. A selection of aluminium roller tubes have been designed specifically to integrate with the operating systems for optimal performance and minimal deflection.

Manually operated systems use a metal or plastic ball chain for operation. This is available in a variety of colours and finishes.

The system can be motorized and also used in combination with other shading products or in conjunction with heating / ventilation systems operated via computer controlled building management programs.

This side control system offers a multiple shade option with either individual or a single common manual or motorized drive. This allows shading of exceptionally large glass areas.

ARCHITECTS
SPECIFIERS
CONTRACTORS

KOPER_k

SIDE CONTROL
Roller System

Side Control Roller System

Exploded diagram: System 38, TOP FIX - Standard Metal Bracket

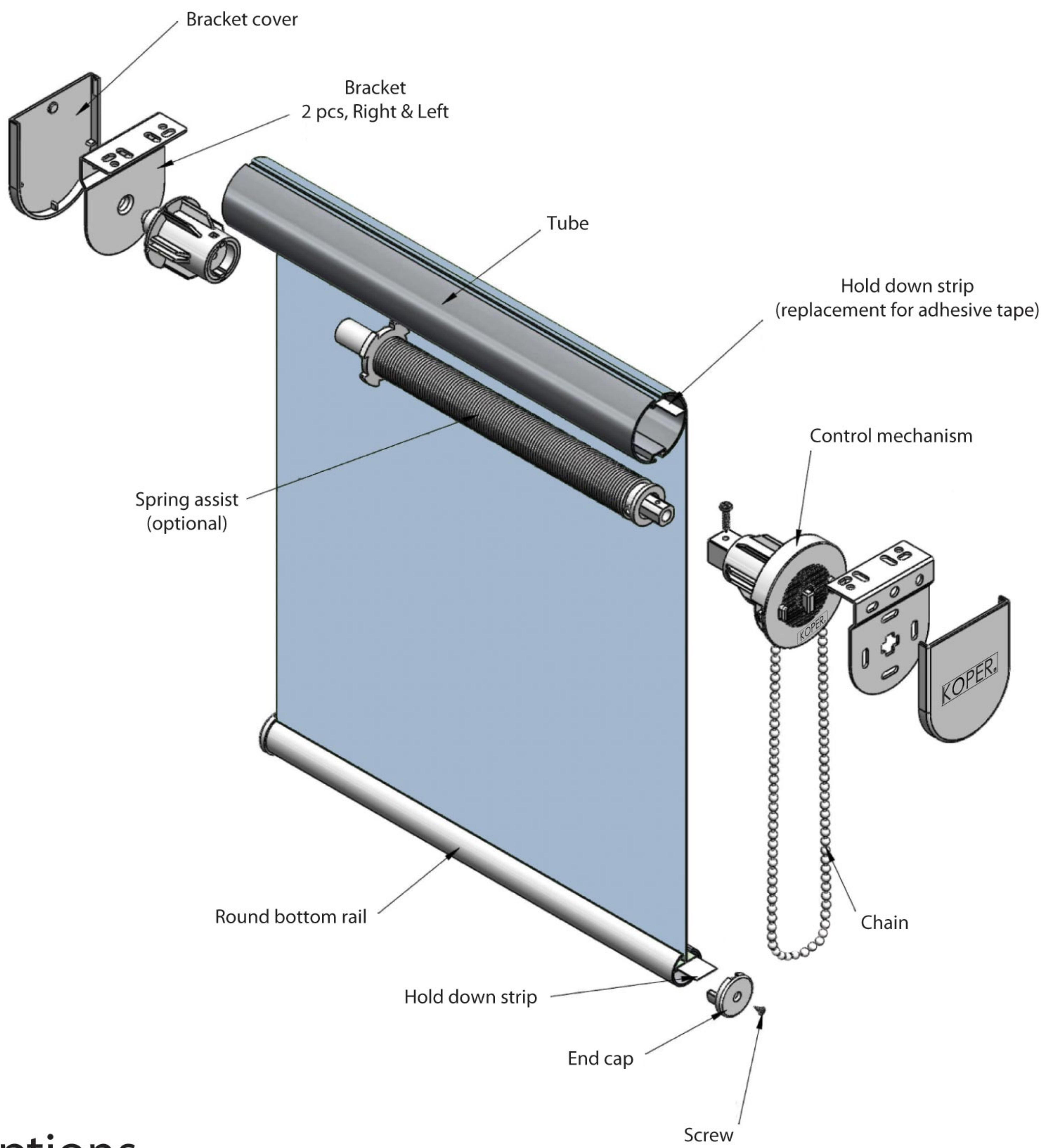

Additional options

3 Inch Curved Fascia (System 38 Inside)

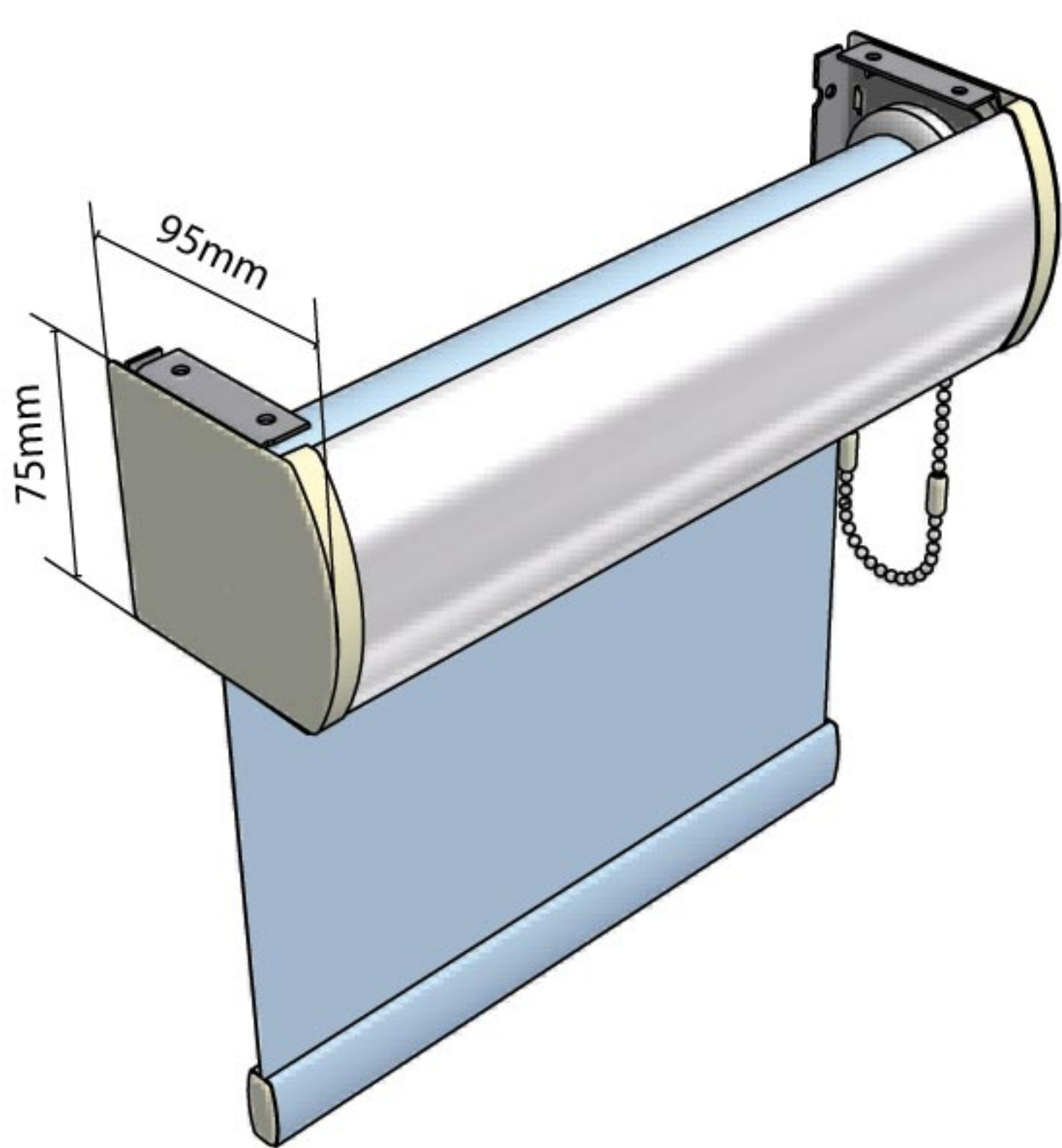

Fascia

With brackets manufactured from heavy gauge stove enamelled steel and fascia from aluminium, these units serve to house the roller shade and operating system. The use of fascia systems can allow window blinds to integrate more easily into particular glazing installations or to effect the desired aesthetic impact.

Colours: white, cream, brown or grey

4 Inch Square Fascia (System 45 Inside)

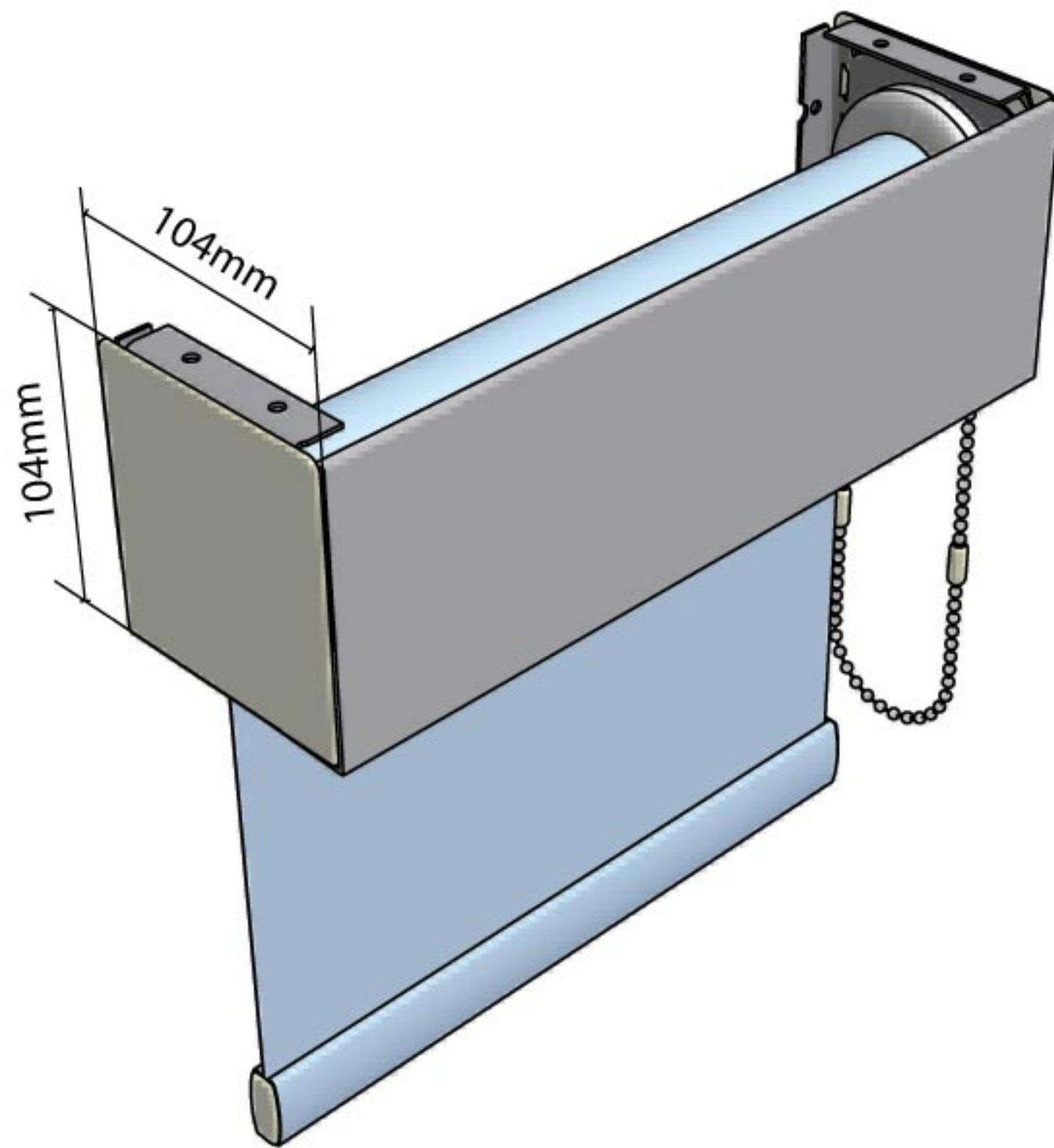

Back Bar Mounting Plate/brackets

Stove enamelled finish to galvanised steel. The mounting brackets are designed to allow top or face fix installations. The bracket design enables quick and simple installation.

Brackets sizes are appropriate to each system and tube size. Extension brackets are available if required. Brackets are colour keyed to operating system colour.

Covers for the mounting brackets are available to suit each size.

Back Bar Mounting Plate / Brackets

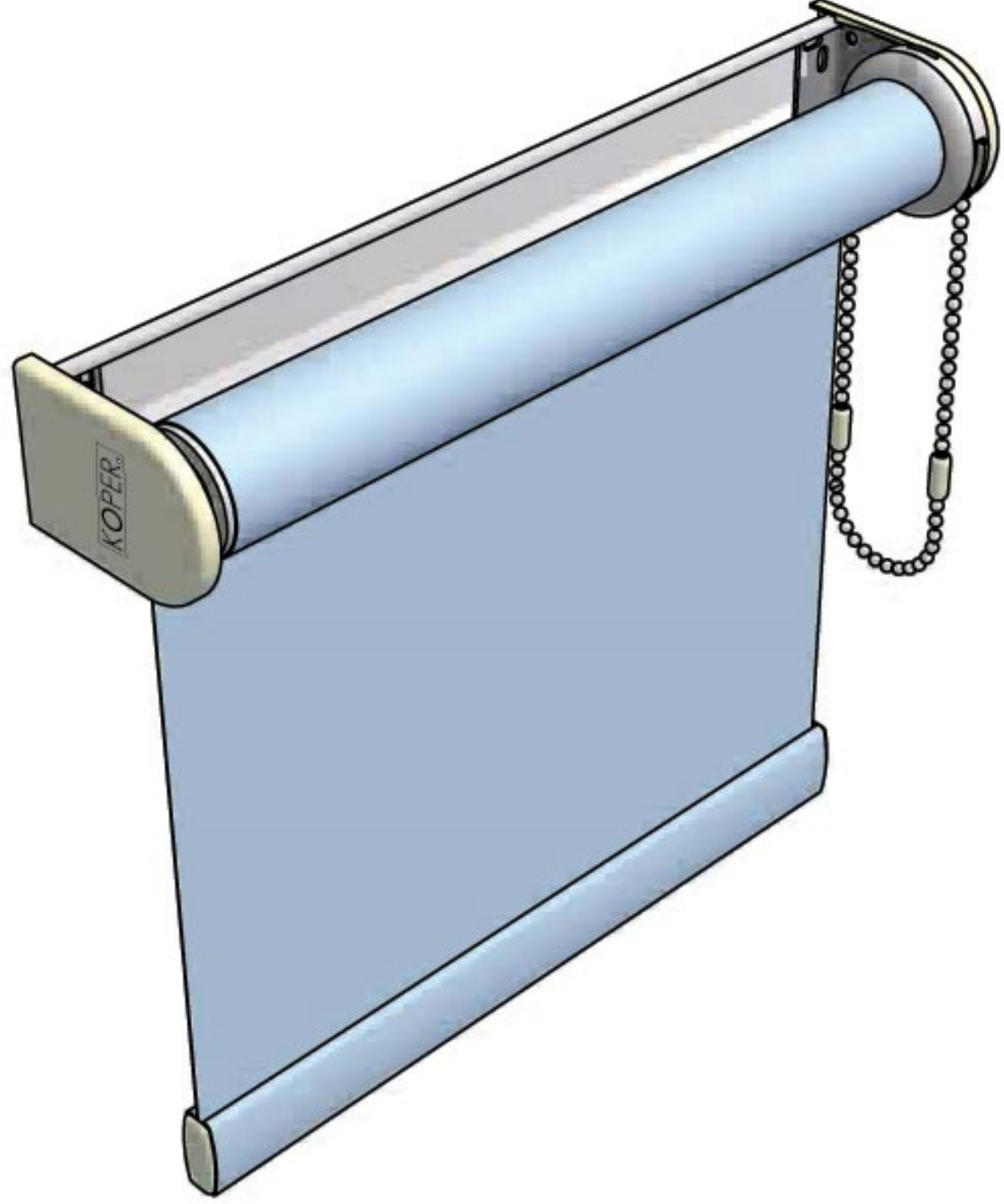

Spring Assist Units

The Spring Assist units enable large, heavy blinds to be operated more easily reducing the effort required by the operator.

The spring fit neatly into the operating system and are totally hidden from view.

Available for system 38 & 45.

3 Inch Curved Cassette (System 38 Insert Type With Chain Guide)

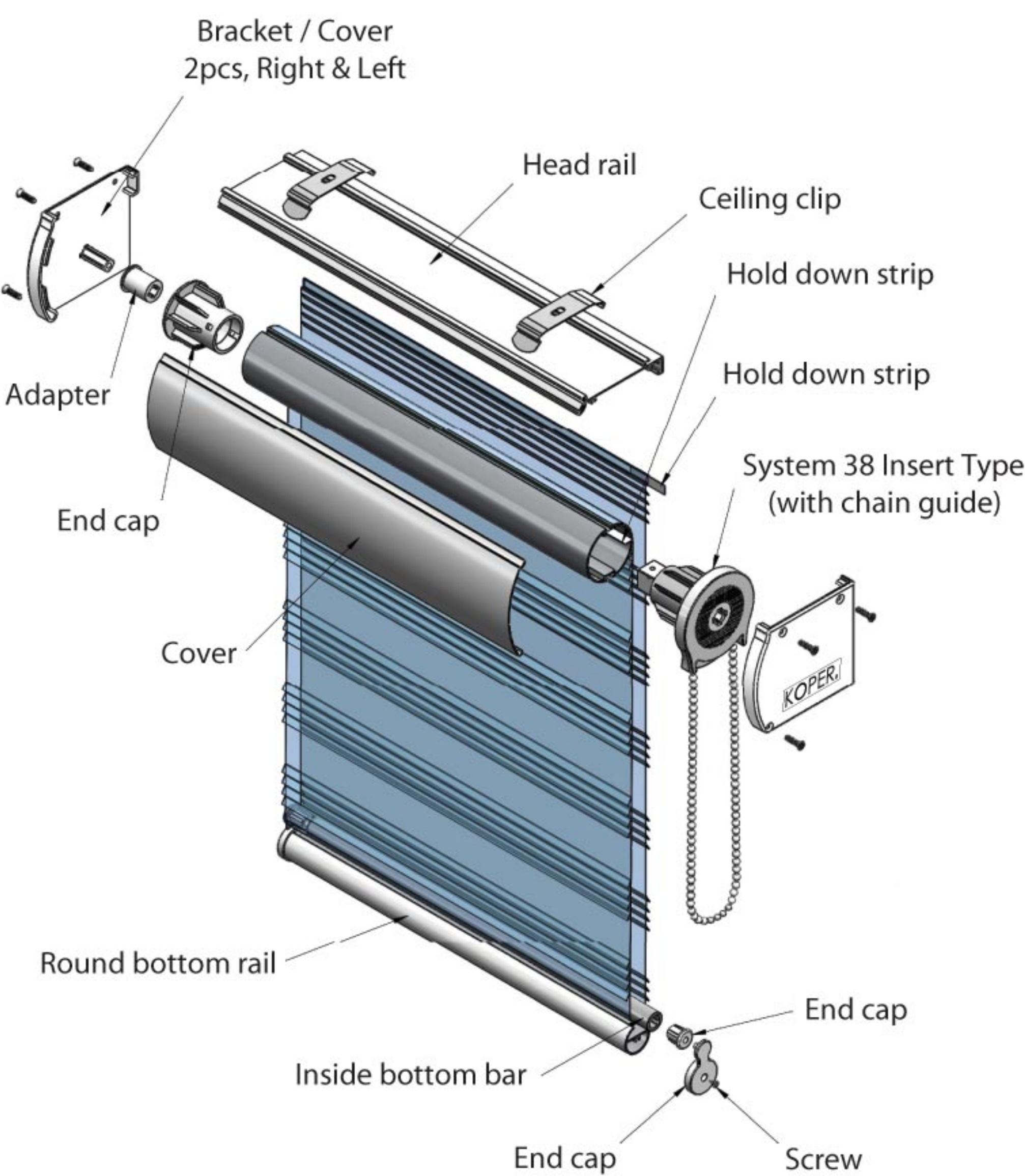

4 Inch Curved Cassette (System 38/45 With Chain Guide)

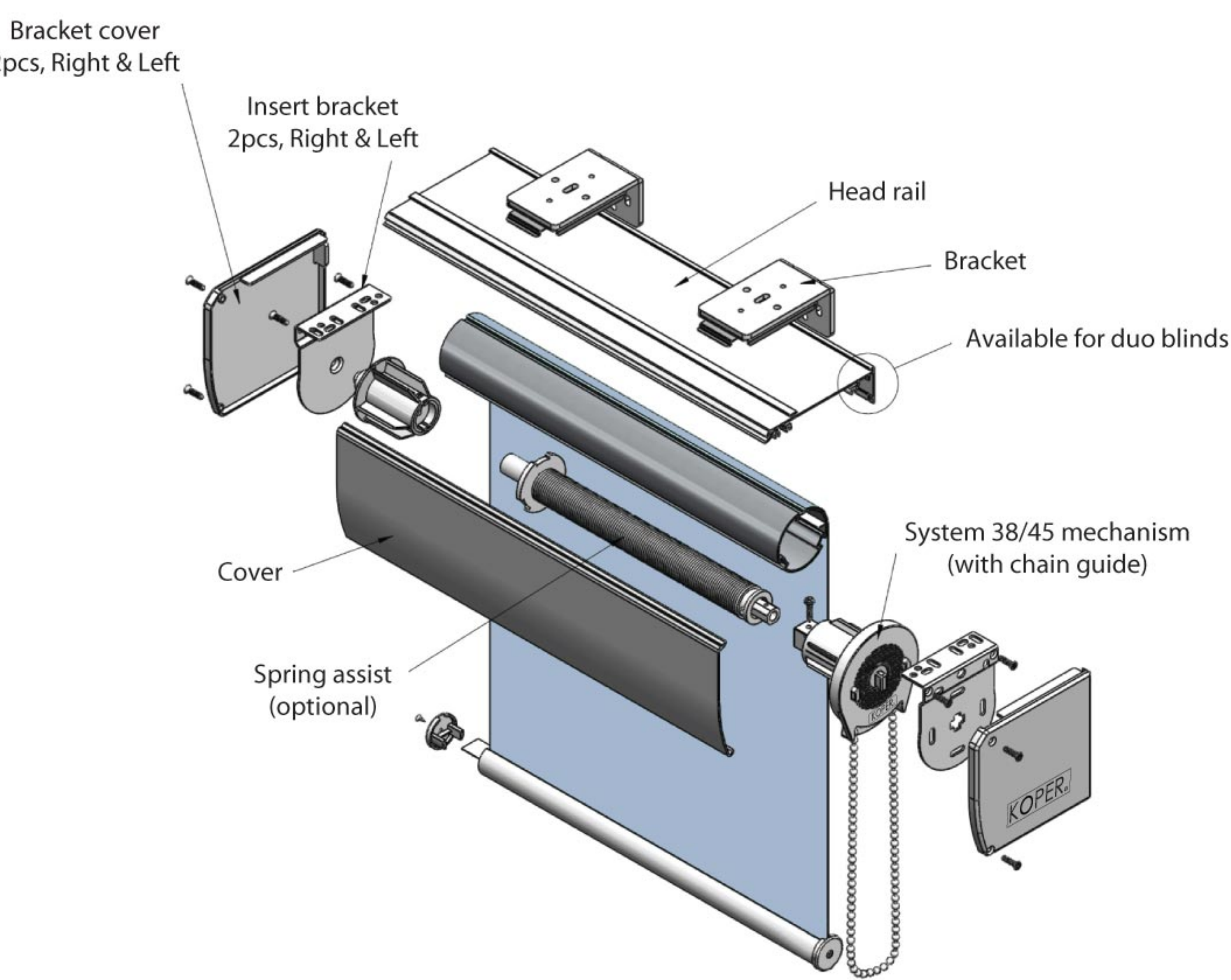

Cassette

All component parts and fabric are enclosed within a rounded fascia resulting in a compact, robust system with a streamlined appearance. Fast, multiple installations can be achieved using brackets that can be fitted along the whole length of the cassette. Available for System 38 & 45. Colours: white, cream, brown or grey

System 38 With Side Cable Guides

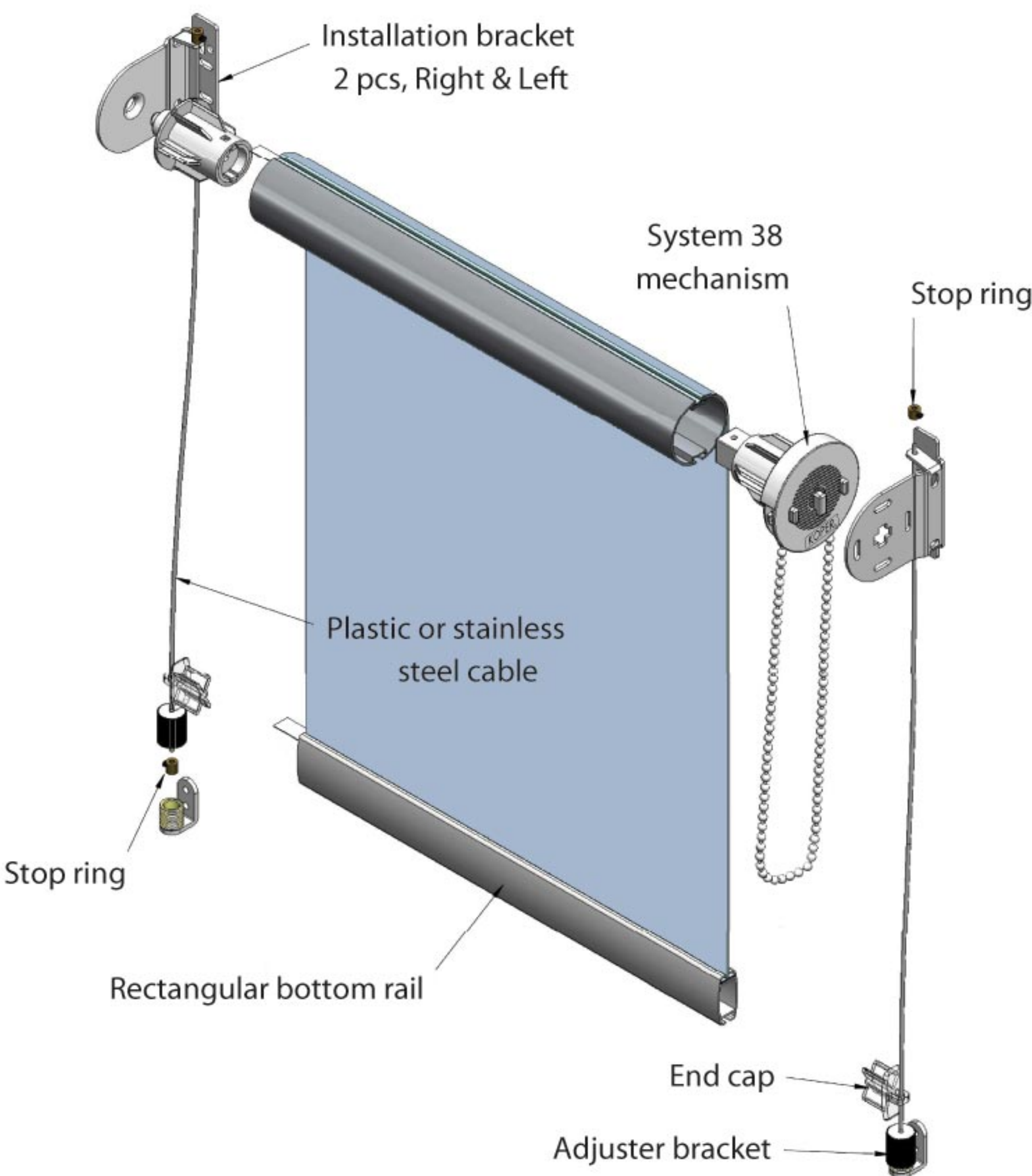

Maximum Recommended Blind Sizes

System	Max. Blind Width	Max. Loading Weight
System 32	1.5 m	2 kg
System 38	2 m	4 kg
System 45	2.5 m	6 kg

Hardware Specification

When specifying hardware requirements please refer to the following statement to avoid receiving blinds not manufactured using genuine operating systems.

Roller Blinds should be manufactured using only genuine KOPER products utilizing aluminium tube of 31.8mm (1 ¼”), 40mm (1 ⅝”) or 45mm (1 ¾”) outside diameter.

The operating units will feature a patented chain drive unit incorporating a locking device and a spring loaded plunger end location assist.

Brackets will be of universal fixing type colour keyed to the operating systems and the bottom rail will be manufactured from aluminium.

The fixing method of the fabric to the hardware will require a double face adhesive tape or a hold down strip locking system to ensure full integrity of the system.

A full advisory service is offered should you require further clarification or a demonstration of the side control chain operated roller systems.

Side Control Components

Control End - System 32, 38 & 45

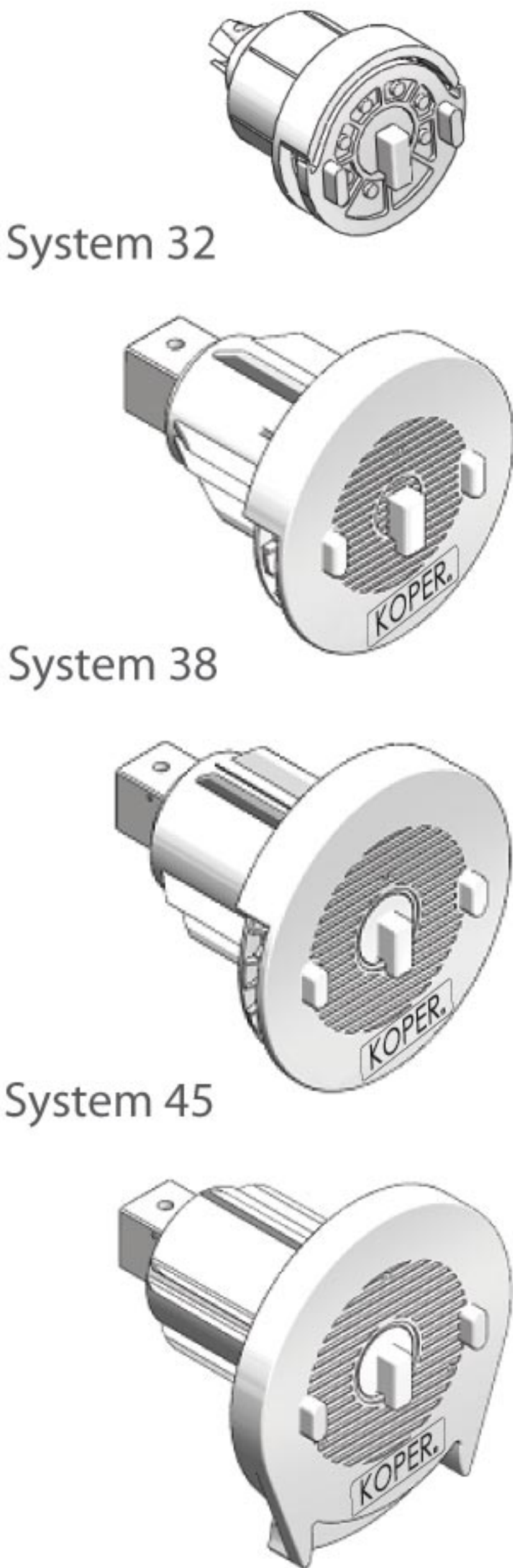

System 32

System 38

System 45

System 38/45 (with chain guide)

Patented universal side control operating unit featuring stainless steel/bezinal wrap spring clutch mechanism. The control end unit features a locking feature to secure the unit into the bracket. The operating unit comes in a variety of sizes, 32/38/45, for ease of operation even on large heavy shades. Available in a variety of colours.

Product Specification

Sprocket / sprocket guard acetal
Other parts glass filled nylon 6
Spring lock friction system
Unique bracket securing pin
Choice of nylon or metal chain drive
Colours: white, cream, brown or grey

Brackets (metal) and Bracket Covers

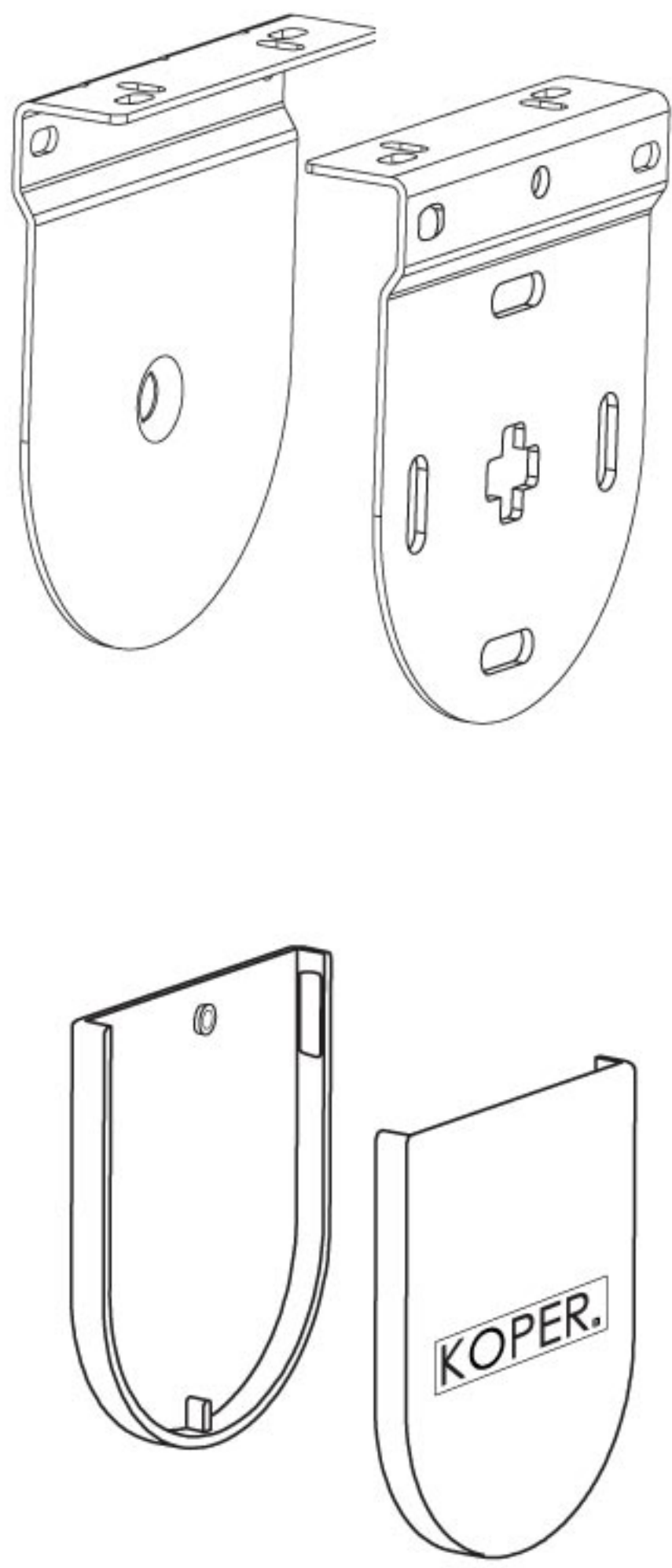

Mounting Brackets

Stove enamelled finish to galvanised steel. The mounting brackets are designed to allow top, face or side fix installations. The bracket design enables quick and simple installation whilst minimising the light gap between the blind and any recess.

The brackets sizes are appropriate to each system and tube size. Extension brackets are available if required. Brackets are colour keyed to operating sysem colour. Covers for the mounting brackets are available to suit each size.

Product Specification

Universal fixing points: side, face or top fix
Mild steel, zinc plated and power coated
Thickness: 1.7mm
20mm wide fixing plate
Colours: white, cream, brown or grey

Bracket Covers

Available to suit each size of bracket

Product Specification

Glass filled nylon
Colours: white, cream, brown or gey

Plunger End - System 32, 38 & 45

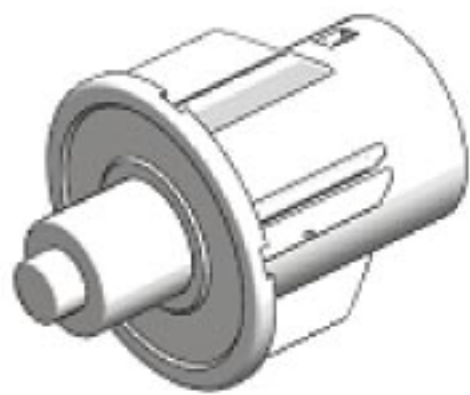

Plunger End System

A spring loaded plunger end allows for quick and easy installation by a single individual, even on larger blinds.

Product Specification

Nylon 6
Colours: white, cream, brown or grey

Chain

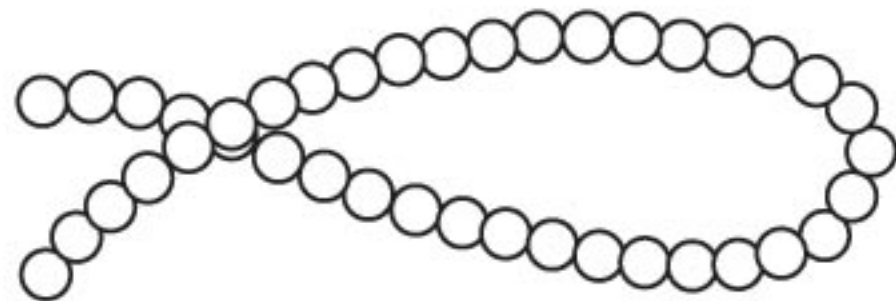

The pitch of the operating chain is designed to provide a smooth and silent operation.

Product Specification

Ball diameter = 4.5mm , available types:
Acetal ball - color: clear, white, cream, brown or grey (Ball pitch = 6.2mm)
Stainless steel (Ball pitch = 6mm)
Nickel plated brass (Ball pitch = 6mm)
Nickel plated steel (Ball pitch = 6mm)

Standard Tube - System 32, 38 & 45

Side view

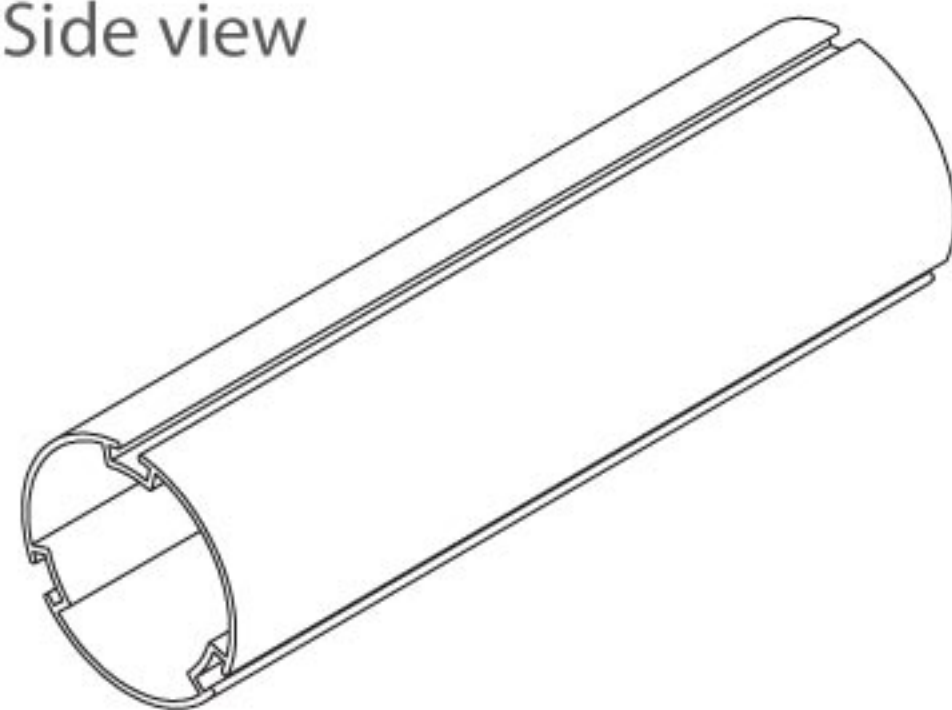

End views



System 32



System 38



System 45

Tempered aluminium tube is used ensuring a high degree of torsional strength. The design allows for full integration of the selected fabric and also provides maximum resistance to tube deflection.

Different tube sizes are available, each being designed to work in conjunction with the appropriate operating system.

Product Specification

Aluminium
Length: 5.8m (6.3 yards) or 6m (6.6 yards)

System 32 : Outside diameter: 31.8mm (1 1/4"),
wall thickness: 0.95mm (3/64"), fabric locating slot: 1

System 38 : Outside diameter: 40mm (1 18/32"),
wall thickness: 1.25mm (3/61"), fabric locating slot: 2

System 45 : Outside diameter: 45mm (1 25/32"),
wall thickness: 1.3mm (3/60"), fabric locating slot: 3

Motor Adapters

Motor adapter for system 38 brackets (plastic)

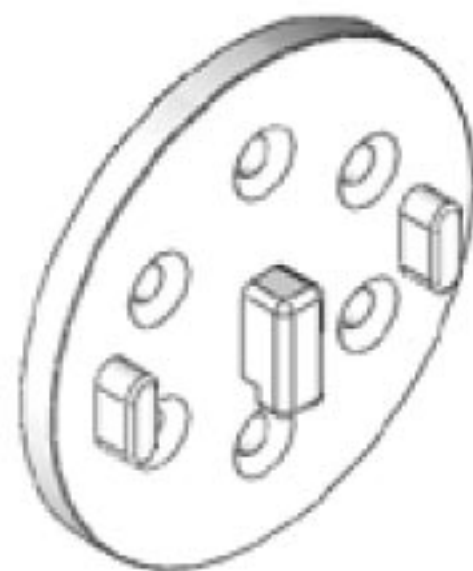

Motor adapter for system 38 brackets (metal)

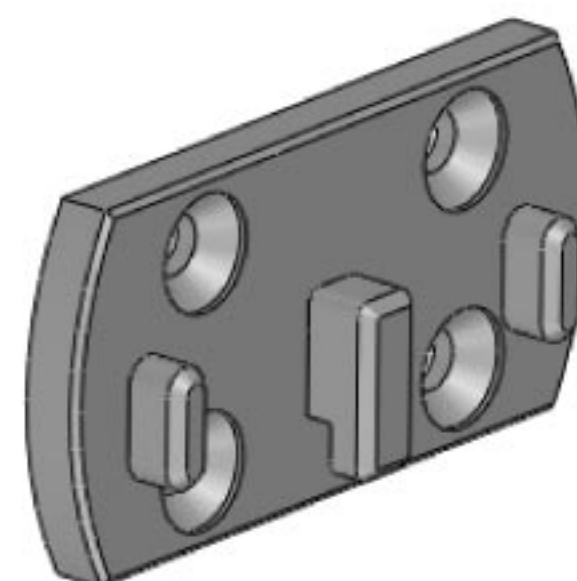

Motor adapter for system 45 brackets (plastic)

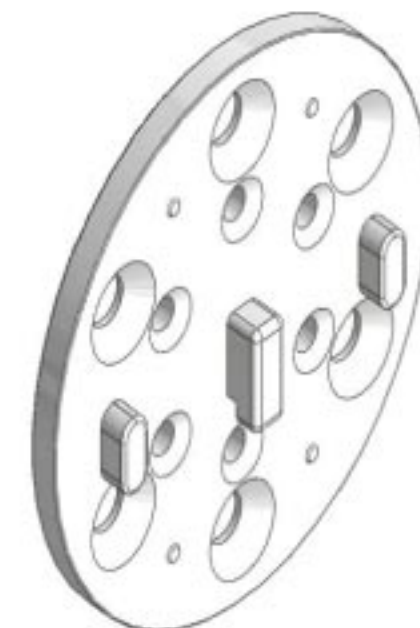

Tube For Motors

System 45

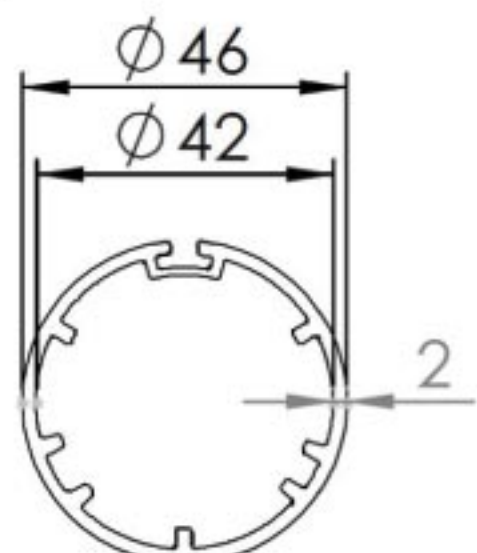

System 55

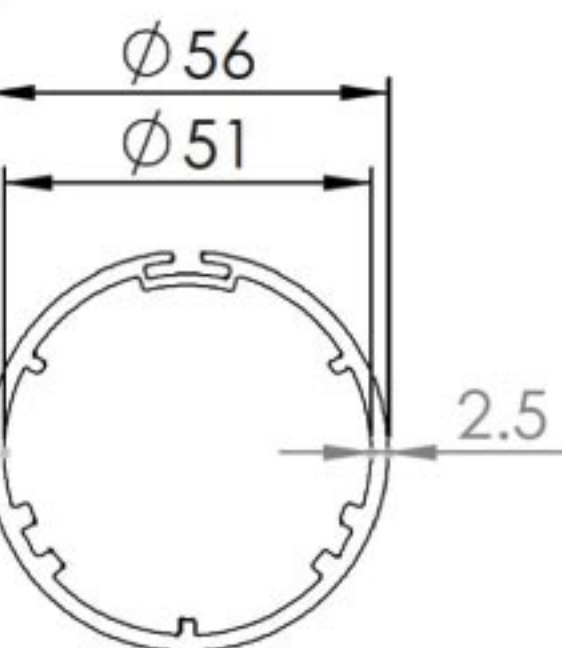

Product Specification

Aluminium
Lengths: 6m (6.6 yards)

System 45 : Outside diameter: 46mm (1 25/32"),
wall thickness: 2mm (3/64"), fabric locating slot: 1

System 55 : Outside diameter: 56mm (2 1/5"),
wall thickness: 2.5mm (1/10"), fabric locating slot: 1

Tube Adapters

Adapter for system 38 with tube 45



Adapter for system 45 with tube 55



Side Control Components

Bottom Bar		Bottom Bar End Caps	
Round	Round and oval rails are available in aluminium in anodised, white, cream or brown finish. Rectangular rails are available in only white finish.	Round	Co-ordinating end caps apply the appropriate finish to the bottom rail assembly.
Rectangular	Product Specification Round Length: 5.1m (5.6 yards) Outside diameter: 21.3mm Thickness: 1.2mm Rectangular Length: 5.8m (6.3 yards) Overall dimensions: 14.5 x 30mm Thickness: 1.2mm Oval Length: 6m (6.6 yards) Overall dimensions: 20.4 x 30.5mm Thickness: 1.3mm	Rectangular	Product Specification Round: nylon / polypropylene Colour: white, cream, brown or grey Rectangular: nylon / polypropylene Colour: white
Oval		Oval	Oval: nylon / polypropylene Colour: white, cream, brown or grey

Bottom Bar For Duo System		Bottom Bar End Caps For Duo System	
Round	Round, U-shape and oval rails are available in aluminium in anodised, white, cream or brown finish.	Round	Co-ordinating end caps apply the appropriate finish to the bottom rail assembly.
U-shape	Small rails are used in conjunction to hold the fabric above the main rails.	U-shape	Product Specification Round: nylon / polypropylene Colour: clear U-shape: nylon / polypropylene Colour: white, cream, brown or grey
Oval	Product Specification Round Length: 5.1m (5.6 yards) Outside diameter: 21.3mm Thickness: 1.2mm U-shape Length: 5.8m (6.3 yards) Overall dimensions: 25.4 x 40mm Thickness: 1.3mm Oval Length: 5.8m (6.3 yards) Overall dimensions: 24.5 x 32.5mm Thickness: 1.2mm	Oval	Oval: nylon / polypropylene Colour: white, cream, brown or grey

Side Cable System Accessories		Side Cable System Accessories	
Adjuster bracket (painted white)	End cap with ring for round bottom rail (plastic - white)	Cable holder (nickel plated)	End cap with ring for rectangular bottom rail (plastic - clear)

SC Series - Universal Bracket Dimensions

System 32

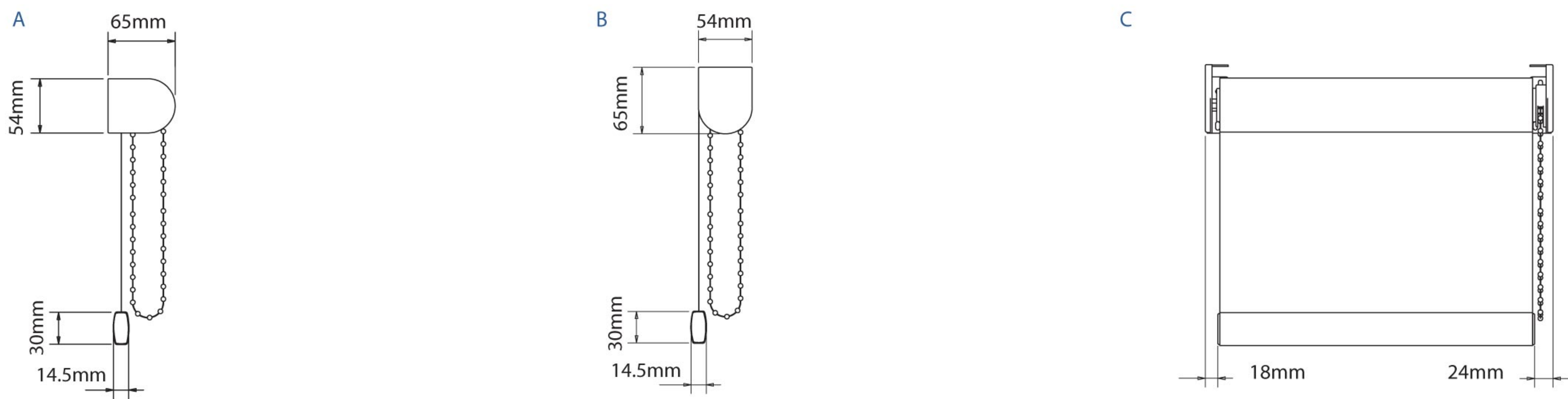

System 38

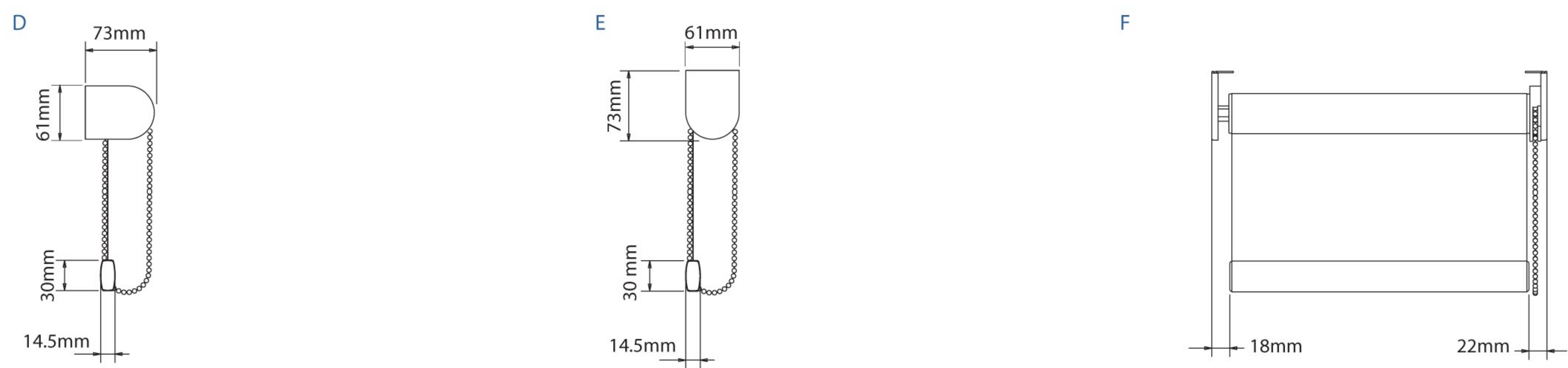

System 45

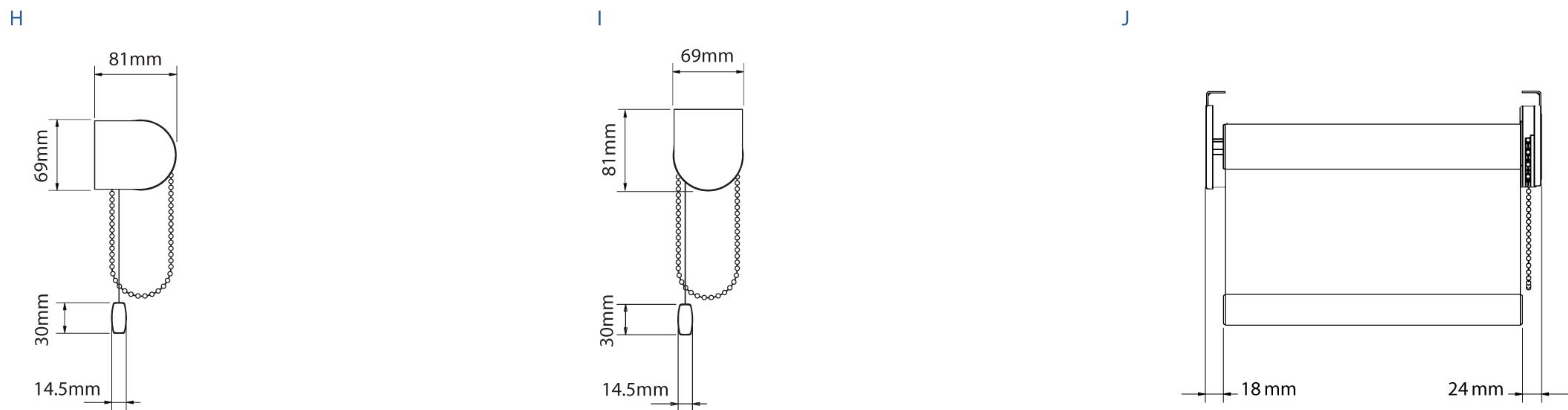

EXTENDED METAL BRACKET

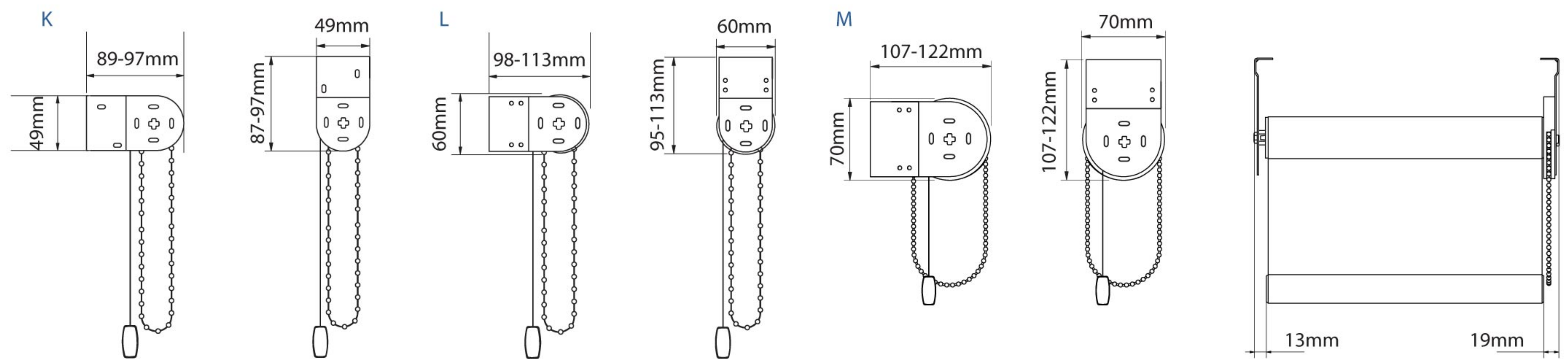



WARRANTY

Dear Customer,

KOPER guarantees that all its window covering products are free from material and assembly defects, provided that such products were properly installed in a domestic situation.

The obligation of KOPER is limited to repair or replacement of the defective materials or components with like or similar parts.

The guarantee is limited to the original purchaser.

CONDITIONS

WHAT IS COVERED

Products are warranted against original defects in materials or workmanship during the specified warranty period.

WHAT IS NOT COVERED

This warranty does not cover:

- Damage or failure caused by accident, misuse, or improper installation, maintenance, cleaning or handling
- Damage caused by pets, insects or exposure to salt air
- Discoloration or fading over time
- Warpage through exposure to high humidity (for wood products)
- Cost of removal, transportation and reinstallation of the product
- Variations in colors from lot to lot (colors may not exactly match samples or previously purchased products)
- For all products other than exterior solar shades, damage resulting from non-interior applications, exposure to outdoor elements, or extremely high humidity environments
- Some slight warpage, as well as natural variations in color and grain which are normal with a wood product and are not considered defects

SCOPE OF WARRANTY

• All Internal Mechanisms	2 Years
• Components & Brackets	2 Years
• Operational Cords & Chains	2 Years
• Fabrics, Wood & Aluminum (material defects)	2 Years
• Motorization components (batteries excluded)	5 Years
- limited manufacturer's warranty	

NOTE: In no event shall KOPER be liable for loss of profits or revenues, or for any indirect, incidental, consequential or similar damages arising out of the sale of the product to the customer, or any claim made against the customer by any third party.

This guarantee does not affect the consumers rights against "KOPER Dealer" arising from their sales/purchase contract.

ASK FOR YOUR WARRANTY UPON PURCHASING ANY KOPER PRODUCT

KOPER roller system supplied by:

TO OBTAIN WARRANTY SERVICE:

1. Contact "KOPER Dealer" from whom you purchased the product
2. Provide him with the "Warranty Ref." located at the upper right of your warranty document

Roller Blind System - Multiple blind options



Two controls intermediate bracket



Single control intermediate bracket

Two controls intermediate bracket

The "Two controls intermediate bracket" allows two blinds to have fully independent operation whilst sharing a common centre support bracket. Such a combination can prove of use when covering a large glass area and with the need to negate the deflection, whilst minimising spacing between blinds. In addition, such installations offer the opportunity of covering two openings of different drops with a shared intermediate bracket.

Single control intermediate bracket

The "Single control intermediate bracket" allows multiple blinds to be joined together with a shared single control mechanism. This facilitates one action being required to raise or lower the blinds simultaneously. The capacity of the lifting mechanism is dependent upon the performance rating of the operating unit.

The "Single control intermediate bracket" also allows multiple blinds to be driven by a single powered drive.

Power drive options

The side control operating system can be used in conjunction with Somfy Power Drive systems either as individual blinds or as part of a building management control system.



Power drive options